

Spring Retractable Single Line Fuel Gas Welding Hose Reels



Series SW - 1/4", 3/8" I.D.

Reel

- Hard coated, wear-resistant aluminum double-sealed full flow swivel
- Corrosion resistant baked-on powder coat

Hose

- Ideal for welding service – meets ARPM IP-7 and CGA E-1 standards for T-grade
- Non-conductive
- **Tube:** Synthetic rubber compound compatible with all common welding fuel gases
- **Reinforcement:** Spiral synthetic yarn
- **Cover:** Red synthetic rubber with ribbed surface



NOTE: All Series SW reels are listed to UL 1351 (reel only)



Interactive Reel Catalog

Visit reelcraft.com/catalog for complete product specifications, parts, and accessories.

NEW!

Reel Covers

See page 41

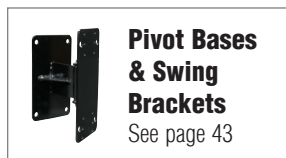

Features

- Designed to improve safety in the work area with an increase in productivity and efficiency
- Full flow shaft swivels
- Double-sealed, O-rings prevent leakage
- Durable abrasion and corrosion resistant baked-on red powder-coated finish
- Reel frame, spool, and drum are fabricated of heavy gauge steel

Fuel gases commonly used in the welding, pre-heating, soldering, brazing, laboratory, heat gun, and cutting industries including, but not limited to, Acetylene, Hydrogen, Methane, Natural Gas, LP Gas, Mapp, and Propane

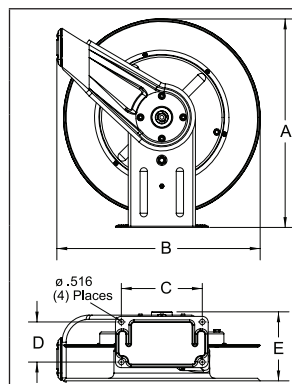

	Size Index					
	1		2		3	
	in	mm	in	mm	in	mm
A	12 ⁷ / ₈	327	20 ¹ / ₄	514	20 ¹ / ₄	514
B	12 ⁵ / ₈	321	19 ³ / ₄	502	19 ³ / ₄	502
C	8	203	7 ⁷ / ₈	200	7 ⁷ / ₈	200
D	2 ¹ / ₂	64	3 ⁷ / ₈	98	3 ⁷ / ₈	98
E	5 ⁵ / ₈	143	7	178	8 ¹ / ₄	210

SW4000 reels have four 5/16" (8 mm) diameter mounting holes.

Model with hose & bumper	Shipping Weight		Hose I.D.		Hose O.D.		Hose Length		Max Pressure		Hose Outlet B Size LH Thread	NPT(F) Reel Inlet	Reel Outlet	Size Index #
	lbs	kg	in	mm	in	mm	ft	m	psi	bar	in	in	in	
Single Line Fuel Gas Welding Reels Maximum Temperature 150 °F (65 °C)														
SW4425 OLPT	19	9	1/4	6	0.53	13	25	8	200	14	9/16 - 18(F)	1/4	9/16-18(F)	1
SW7650 OLPT	43	20	3/8	10	0.66	17	50	15	200	14	9/16 - 18(F)	1/2	9/16-18(M)	2
SWHD76050 OLPT	45	20	3/8	10	0.66	17	50	15	200	14	9/16 - 18(F)	1/2	9/16-18(M)	2
SWHD76100 OLPT	75	34	3/8	10	0.66	17	100	30	200	14	9/16 - 18(F)	1/2	9/16-18(M)	3