

## Hand Crank and Motor Driven Reels

### Series 30000 - Air/Water/Oil - 1/2", 3/4", 1" I.D.



- Designed for rugged applications requiring long lengths of hose and large storage capacity
- All-bolted unitized construction, full flow swivel and heavy gauge steel frame, spool, and drum ensure longest service life
- Vibration-proof, self-locking fasteners are ideal for industrial use
- Optional lock pin to prevent spool rotation when the reel is not in use, S600874



Removable gooseneck makes hose installation easy.



CA32112 L

<b>E</b>	<b>A</b>	<b>3</b>	<b>3</b>	<b>1</b>	<b>06</b>	<b>L</b>	<b>12D</b>
<b>Drive Type</b> A - Air motor B - Bevel crank C - Hand crank E - Electric motor	<b>Swivel Size</b> 2 - 1/2" (13 mm) I.D. 3 - 3/4" (19 mm) I.D. 6 - 1/4" (6 mm) Dual 7 - 1" (25 mm) I.D. 8 - 1/2" (13 mm) I.D. pressure wash	<b>Width of Spool</b> See "F" Dimension 06 - 6" (152 mm) 12 - 12" (305 mm) 18 - 18" (457 mm)		<b>Motor Voltage/H.P.</b> Blank 12D - 12 V DC 4A - 1/2 HP air motor			
<b>Fluid Path Type</b> A - Gooseneck H - Heavy duty gooseneck (1" only)		<b>Pressure</b> L - 1000 PSI (69 bar) M - 3000 PSI (207 bar)					

**NOTE:** Chart is for reference only. Not all options available in every combination. Reels cannot be ordered by selecting from this chart.

### Additional Series 30000 Models

- Pressure Wash - Page 23
- Welding Gas - Page 35
- Garden Reels - Page 24
- Welding Cable - Page 37

Hose I.D.	1/4"	3/8"	1/2"	3/4"	1"
	6 mm	10 mm	13 mm	19 mm	25 mm
Hose O.D.	.530"	.710"	.850"	1.188"	1.375"
	13 mm	18 mm	22 mm	30 mm	35 mm
"F" Width	Hose Capacity				
6" (152 mm)	200' 61 m	140' 43 m	100' 30 m	50' 15 m	N/A
12" (305 mm)	425' 130 m	300' 91 m	200' 61 m	100' (30 m)	50' (15 m)
18" (457 mm)	625' 191 m	450' 137 m	325' 99 m	175' (54 m)	100' (31 m)

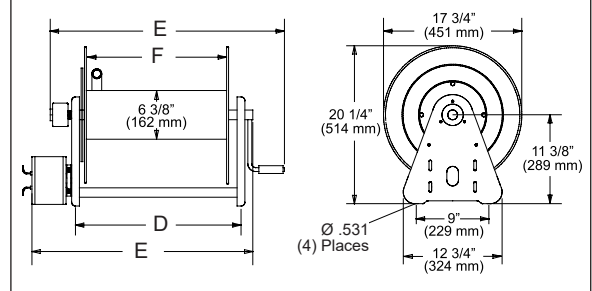

Model without hose & bumper	Shipping Weight		Hose Capacity				Max Pressure	NPT(F) Reel Inlet	NPT(F) Reel Outlet	D	E	F
	lbs	kg	I.D.	O.D.	Length							
<b>Manual Hand Crank Hose Reels</b> Maximum Temperature 210 °F (99 °C)												
CA32106 L	40	18	1/2 13	.750 19	100 30	1000 69	1/2	1/2	9 3/4 248	19 3/4 502	6 152	
CA32112 L	46	21	1/2 13	.750 19	200 61	1000 69	1/2	1/2	15 3/4 400	25 3/4 654	12 305	
CA32118 L	51	23	1/2 13	.750 19	325 99	1000 69	1/2	1/2	21 3/4 552	31 3/4 806	18 457	
CA32106 M	42	19	1/2 13	.850 22	100 30	3000 207	1/2	1/2	9 3/4 248	19 3/4 502	6 152	
CA32112 M	46	21	1/2 13	.850 22	200 61	3000 207	1/2	1/2	15 3/4 400	25 3/4 654	12 305	
CA32118 M	52	24	1/2 13	.850 22	325 99	3000 207	1/2	1/2	21 3/4 552	31 3/4 806	18 457	
CA33106 L	41	19	3/4 19	1.075 27	50 15	1000 69	3/4	3/4	9 3/4 248	19 3/4 502	6 152	
CA33112 L	46	21	3/4 19	1.075 27	100 30	1000 69	3/4	3/4	15 3/4 400	25 3/4 654	12 305	
CA33118 L	51	23	3/4 19	1.075 27	175 53	1000 69	3/4	3/4	21 3/4 552	31 3/4 806	18 457	
CA33112 M	47	21	3/4 19	1.188 30	100 30	3000 207	3/4	3/4	15 3/4 400	25 3/4 654	12 305	
CH37118 L*	64	29	1 25	1.375 35	100 30	1000 69	1	1	21 3/4 552	34 1/4 870	18 457	
<b>Electric Motor Driven Hose Reels</b> Maximum Temperature 210 °F (99 °C)												
EA32112 L12D	64	29	1/2 13	.750 19	200 61	1000 69	1/2	1/2	15 3/4 400	23 7/8 606	12 305	
EA32118 L12D	68	31	1/2 13	.750 19	325 99	1000 69	1/2	1/2	21 3/4 552	29 5/8 752	18 457	
EA33106 L12D	63	29	3/4 19	1.075 27	50 15	1000 69	3/4	3/4	9 3/4 248	19 5/8 498	6 152	
EA33112 L12D	68	31	3/4 19	1.075 27	100 30	1000 69	3/4	3/4	15 3/4 400	23 7/8 606	12 305	
EA33118 L12D	68	31	3/4 19	1.075 27	175 53	1000 69	3/4	3/4	21 3/4 552	29 5/8 752	18 457	
EH37118 L12D*	82	37	1 25	1.375 35	100 30	1000 69	1	1	21 3/4 552	31 787	18 457	
<b>Air Motor Driven Hose Reels</b> Filter, regulator, lubricator required. Maximum Temperature 210 °F (99 °C)												
AA33106 L4A	59	27	3/4 19	1.075 27	50 15	1000 69	3/4	3/4	9 3/4 248	17 1/4 438	6 152	

**CAUTION:** To prevent drum damage fully extend and pressurize hose and rewind on the reel. \*All 1 in. reel models have an 8 in. (203 mm) diameter drum.

Many more reel models available in addition to chart. Refer to reelcraft.com for details.